

7/28, 2014

City of Pleasanton
Planning Department

Dear Ladies and Gentlemen:

In the process of submitting our application, we discovered the agenda for the August 13 2014 for the committee meeting is full. Unfortunately we have notified our parents school is starting on September 7. Due to the time sensitive nature of our application, we were hoping to have our application reviewed on the August 13th meeting instead of the one at the end of August.

Thank you for your time.

Sincerely,

shuangshuang Wang

Shuang Shuang Wang and Yani Rong

7/27/14

Yani Rong

7/27/14

P14-1128
RECEIVED

JUL 28 2014

**CITY OF PLEASANTON
PLANNING DIVISION**

EXHIBIT B

7/28, 2014

City of Pleasanton
Planning Department

RE: Conditional Use Permit for 5001 Case Ave. Pleasanton, CA 94566 (Pleasanton Middle School)

Dear Ladies and Gentlemen,

This is written on behalf of ShuangShuang Wang and Yani Rong, the owners of Shuang Chinese LLC. dba. Shuang Chinese School for the aforementioned property, 3 classrooms in Pleasanton Middle School. We are proposing to obtain a conditional use permit to accommodate 90 students.

Introduction and Business History:

ShuangShuang Wang has been running a Chinese school in Cupertino, California since 1998. She is also an author of the renowned textbook "Chinese Language and Culture Course." The textbook are utilized worldwide in places such as England, Germany, Canada, Thailand, Indonesia, and Hong Kong. Select textbooks are also being used by San Francisco, Hayward and Cupertino school districts.

ShuangShuang Wang has earned an excellent reputation and received high remarks from her students and parents.

*Please see Attachment 1

Operation Hours and Program description

Shuang Chinese School is a weekend Chinese school, offering Chinese classes for children ranging from 10 to 15 years old (approx 5th to 10th grade). Shuang Chinese School will be open on Sundays from 2:00pm to 5:00pm for school age students only. Our school year will coincide with the school district schedule by observing winter and summer breaks. We will have 30 sessions during our school year.

Chinese classes:

Grade	Class time	Max number of the students	Classroom #	Class Topic
Chinese Grade 5	2:00pm-3:30pm	15	#602	Chinese idioms and Chinese Geography
Chinese Grade 6	3:30pm-5:00pm	15	#602	Stories of ancient Chinese myths and legends
Chinese Grade 7	2:00pm-3:30pm	15	#603	Chinese literature appreciation

Chinese Grade 8	3:30pm- 5:00pm	15	#603	15	Ancient Chinese philosophy
Chinese Grade 9	2:00pm- 3:30pm	15	#604	15	Chinese History 1
Chinese Grade 10	3:00pm- 5:00pm	15	#604	15	Chinese History 2

Transportation:

Students will be dropped off and picked up to and from the classrooms. Shuang Chinese School will provide Safety Guards to guide the vehicles.

Parking:

Shuang Chinese School will use Pleasanton Middle School Parking lots

Security:

Shuang Chinese School will require all students be signed in and signed out in a log book. All authorized adults are required to show their driver's licenses for identification at the time of pickup.

Summary:

In conclusion, I feel that the minimal parking requirements needed by Shuang Chinese School will not pose any issues for nearby existing businesses and that the city, parents, and students will highly benefit from allowing Shuang Chinese School to quickly obtain a CUP to increase the number of students allowed at this location.

Sincerely,

ShuangShuang Wang, Yani Rong

ShuangShuang Wang Yani Rong

7/28/14

Introduction and Business History: (Attachment 1)

My name is Shuang Shuang Wang, a principal of Kentwood Chinese school in Cupertino, California.

I graduated from Peking University with a degree in Philosophy. After I worked in the National Academy of Social Sciences, in 1984 I went to the University of Munich as a visiting scholar focus on comparing East and Western cultures. Since I immigrated to the USA on 1990, I have been teaching Chinese, and during 2008 to 2010 I taught Chinese at San Jose State University.

In 1998, I started a weekend Chinese school in Cupertino, CA. At the same time, I spent the next 10 years writing a set of 20 textbooks for my students. My textbook "Chinese Language and Culture Course" is for children age 6 to 16 years old. After completing the course students will be able to recognize and use 2500 Chinese characters; also to understand Chinese geography, history and philosophy.

In my school, students may enjoy the beauty of Chinese poetry and the wisdom of Chinese philosophy. Long story short, this integrative and interactive approach to Chinese learning is aimed to go beyond just teaching and speaking Chinese. In 2005, my textbooks were published by the Peking University Press. In addition my textbooks are being utilized worldwide such as: England, Germany, Canada, Thailand, Indonesia, and Hong Kong. Select textbooks are also being used by San Francisco, Hayward and Cupertino school districts.

Three years ago, I moved to Dublin, where some after school program were using my textbook. However these programs lacked advanced class. In order to meet the demand of parents, I decided to set up another weekend Chinese school to service our community.

When I arrived to the United States 24 years ago, my daughter, 4 years old at the time, sang me an unforgettable song, Johnny Appleseed. He traveled across the USA barefoot with a sack of apple seeds. He planted orchards of apples across the land. As a teacher and an American citizen, I feel the same drive to help my students.

Shuang Shuang Wang

7/27/14

Application for Use of Facilities

Request is hereby made by the undersigned for the use of school facilities.

Name of school Shuang Chinese School Pleasanton M.S.
Shuang Chinese School Organization Making Application
Yani Rong Person Responsible for Organization

yanirong@gmail.com Person Responsible Email Address
952-667-5306 Cell

Date(s) to be Used 9/7/2014 - 6/7/2015 (Sunday) Hour(s) of use 2:00 P.m. TO 5:00 p.m.

Chinese Sunday School Nature of Activity
 _____ Expected Attendance

Admission charge Will not be made Will be made The net proceeds will be used for _____

- The following facilities will be needed.
- Classroom: Room No(s) 3
 - Kitchen
 - Multi-Purpose Room 602
 - Playground/Athletic Field 603
 - Gymnasium 604
 - Library
 - Parking Lot only
- *Equipment needed
- Chairs, folding # _____
 - Tables # _____
 - P.A. System/Amplifier
 - Projector
 - Pool
 - Other

BILLING ADDRESS:
 Responsible party: Yani Rong 94588
 Address: 1055 Nolan Ct. Pleasanton
 Phone: 925-218-2137
 Fax: _____

The Board of Trustees of the Pleasanton Unified School District recognize that school facilities are primarily intended for the education of the children of the District. However, school facilities may be used by residents of the community for the purposes set forth in the Education Code, provided that such use does not interfere or restrict the educational program of the district. Use of various school facilities shall be granted to responsible organizations and groups within the community, subject to the rules and regulations as set forth by the Board of Trustees. An abbreviated statement of Policy and Regulations can be found on the reverse side of this form.

In executing this application, the undersigned certifies that (s)he is an officer or agent of the group making such application. It is further certified that said group holds harmless the school district for any liability arising out of said use of the facilities requested. The facility user agrees to defend and indemnify the District for any and all claims, however caused.

The Facility User agrees to provide the District with a Certificate of Liability Insurance with liability limits no less than \$1,000,000 per occurrence (\$2,000,000 in the aggregate limit). Facility User agrees to provide the District with an additional insured endorsement naming Pleasanton Unified School District as an additional named insured. The insurance carrier must be admitted in the State of California and have an A.M. Best rating of A-VII or higher. This application expires on June 30, _____.

Signature [Signature] Title Vice Principle Date 2/27/2014
 Email: yanirong@gmail.com Address 1055 Nolan Ct. Pleasanton
 Phone 925-218-2137 (H) 925-667-5306 (C) 94588

Approvals:
 Cleared by School Princip. [Signature] Date 3/25/14 Utility Charge Per Hour: \$2.18/Hr
 Approved by [Signature] Date 3/29/14 Facility Charge Per Hour: \$7.52/Hr
 Director of Maintenance Labor Charge Per Hour: \$6.20/Hr
 Supplies/Misc. Fees: \$65.99/Hr

Distribution: White - Director of Maintenance, Canary - Custodian, Pink- Principal Office
 WAREHOUSE # 51060-F 6/10

middle school needs insurance

AVG. Classroom 960^{sq}

Pleasanton Unified School District

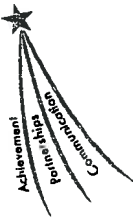

EMERGENCY LOCATION MAP

PLEASANTON MIDDLE SCHOOL

Primary **CC**

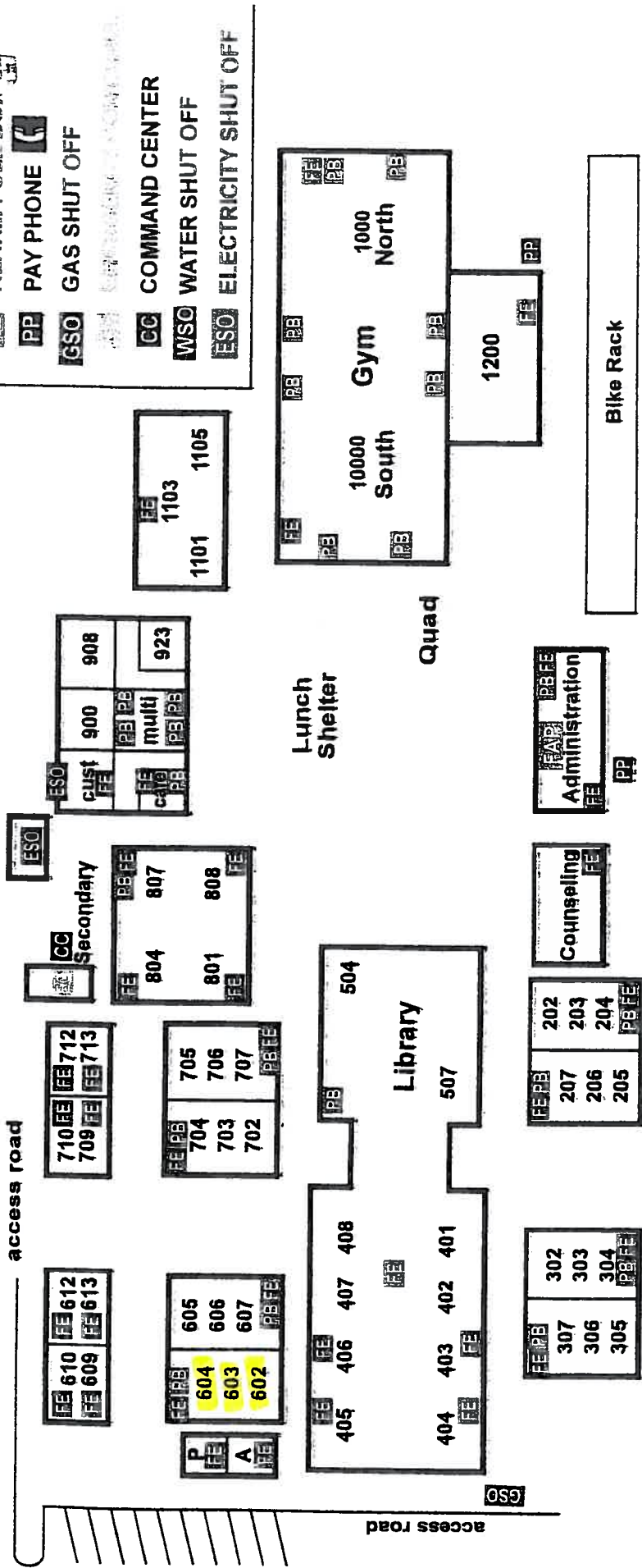

Legend:

- FA** FIRE ALARMS
- FE** FIRE EXTINGUISHERS
- PB** ALARM PULL BOX
- PP** PAY PHONE
- CSO** GAS SHUT OFF
- CC** COMMAND CENTER
- WSO** WATER SHUT OFF
- ESO** ELECTRICITY SHUT OFF

Legend:

- WSO** WATER SHUT OFF
- Parking**
- Parking**
- Side Walk**
- WSO**

Bus Lane

Side Walk

WSO

3 classrooms Floor Plan (Pleasanton Middle School)

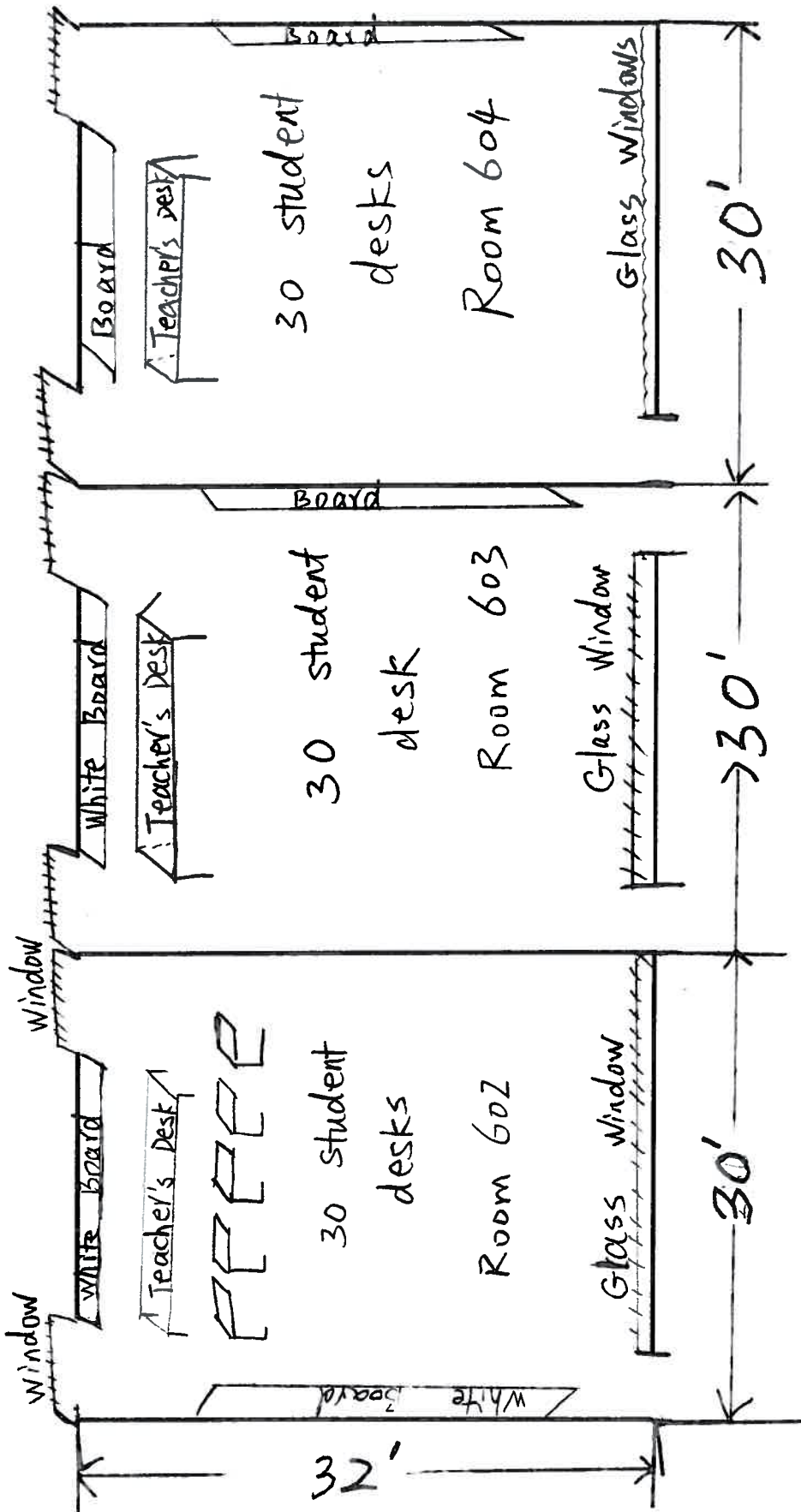

Each classroom is 960 SF