

---

## Tri-Valley Korean-American Parents Association

### I. Who are we?

Tri-Valley Korean-American Parents Association (KPA) was founded in June 2003 and is incorporated in California as a not-for-profit organization to help growing number of Korean-American students in the Tri-Valley area be successful in schools and eventually to become good members of our society.

As of today we have about 300 family members.

### Answers to your letter dated March 12, 2016

#### 1. Narrative

##### a. Maximum Number of People :

**Monthly:** Book distribution – 30 people, there are 55 groups in bookclub, but some of mom has two groups.

**Monthly:** Member meeting – 30 people

**Monthly:** Bazaar – 30 people

**Monthly:** Book Club Meeting – 14 students total, but breaks down into 2 groups, each group with 6 students and 1 leader.

**3 Times a year :** Leadership Training – 40 students total, but break down in to 2 groups, each group with 20 students from 8<sup>th</sup> grade-12<sup>th</sup> grade.

**Weekly:** Mom Choir practice – 15 people

**Weekly:** OPUS Choir practice – 12 students from 1<sup>st</sup> grade – 8<sup>th</sup> grade

**Weekly** Chamber Orchestra – 20 students from 5<sup>th</sup> grade – 11<sup>th</sup> grade

**Weekly** Stretching(7) Guitar(6) Art(3) and Violin(5, 4) Classes. (number of people)

**Occasionally** 20 people On Saturdays, depends on demand

#### - What we will do at this location and use schedule?

All the activities will be place in the gathering space / one open space/

RECEIVED

AUG 09 2016

CITY OF PLEASANTON  
PLANNING DIVISION  
EXHIBIT B

PI 033 |

Multipurpose room. And all the programs are operated only by KPA.

**Location main use schedule (how many people / time)**

<b>Mon</b>	<b>Tue</b>	<b>Wed</b>	<b>Thu</b>	<b>Fri</b>	<b>Sat</b>	<b>Sun</b>
Stretching  7 people  (9:00AM-10:00AM)	Guitar  6 people  (1:00PM-2:30PM)		Art  3 people  (10:00AM-12:00PM)		<b>Monthly</b> Book distribution-  30 people  (9:30AM-10:00AM)	Violin Lesson (Students)  4 students  (10:00AM-1:00PM)
Mom Choir practice  15 people  (10:30AM-12:00PM)			Violin Lesson (Adults)  5 people  (3:30PM-5:00PM)		<b>Monthly</b> Member Meeting-  30 people  (10:00AM-11:00AM)	OPUS Choir practice  12 students  (2:00PM-4:00PM)
						Chamber Orchestra practice  20 students  (4:30PM-6:00PM)
					<b>Once a year</b> Seminar-  10-20 people  (3:00PM-5:00PM)	<b>Monthly</b> Bazaar-  30 people  (3:00PM-3:30PM)
				<b>Monthly</b> Book Club Meeting-  7 students ea team (2 teams)  (4:00PM-5:00PM) (5:00PM-6:00PM)	<b>3 times a year</b> Leadership Training  20 students  (3:00PM-3:40PM)	<b>3 times a year</b> Leadership Training  20 students  (3:00PM-3:40PM)

- On Sunday – Bazaar and Leadership Training never overlap in the time.
- On Sunday - there are no violin lessons when there are bazaars or leadership training.
- On Saturday – Seminar is once a year event and never overlaps with Leadership Training.
- On Saturday – it is the same people who is in book distribution and member meeting

**b. Description of Activities:**

**Monthly:** Book distribution – distributing books to each book club.

Currently we have 55 groups from Kindergarten to 10<sup>th</sup> grade

**Monthly:** Member meeting – our meeting consists mostly announcements for coming events, such as fundraising golf tournaments, Choir and Orchestra performance, etc.

**Monthly:** Bazaar – buy final KIMCHEE package and distribute to members.

**Monthly:** Book Club Meeting - group, who need space to meet

**3 Times a Year:** Leadership Training – KPA invites local teachers or instructors to training bookclub leaders, to the subject how to lead the group successfully.

**Weekly:** OPUS Choir practice – from 1<sup>st</sup> grade – 8<sup>th</sup> grade

**Weekly:** MOM Choir practice – Member's Choir practice

**Weekly:** Chamber Orchestra – from 5<sup>th</sup> grade – 11<sup>th</sup> grade

**Weekly:** Stretching, Guitar, Art and Violin Class

**Occasionally:** On Saturdays having seminars, about health, human trafficking, college preparation, SATII, etc.

**c. Hours of Operation:**

KPA will apply for a **Minor PUD Modification**, to modify the allowed hours of operation to allow for week end activities

**d. Monthly Bazaars:**

We buy final KIMCHEE package and distribute to members. We are not making any KIMCHEE nor repackaging. All the KIMCHEE profit is donated by the vendor \$1 per package sold.

**e. Noise:**

We are NOT using any amplified music for any activities, not even for choir practices and stretching classes.

We are NOT using stereo for the stretching class.

For Orchestra – Violin (8), Viola (4), Cello (6), Flute (2)

**f. Parking Analysis:**

Neighboring businesses office hours:

At 3958 Valley Ave. #A

1. #B – Bay Home – Investment and Loans : M – F 9:00AM-6:00PM
2. #C – Service by Medallion: (nobody were at the office) : By appointment only
3. #D – Premier Pest Management: M-F 8:00-4:30PM
4. #E – The Hitmen – Termite & Pest Control: M – F 7:30AM-5:00PM
5. #F – Vacant
6. #G – Rivers: M – F 8:00AM-5:00PM
7. #H – Restore O & P/ Total Care: M – F 8:00AM-5:00PM

At 3950 Valley Ave.

1. #A - Pool time: M – F 8:00AM-6:00PM, SAT 9:00AM-5:00PM, SUN 9:00AM-4:00PM
2. #B – The Healing Journey: M - F 9:00AM-6:00PM
3. #C – Silmar Flooring: M – F 8:00AM-5:30PM

At 3942 Valley Ave.

1. #A – Southland Construction: M – F 8:00AM-5:00PM
2. #B – Boster Biological Technology: M – F 8:00AM-5:00PM
3. #C – Vacant
4. #D - Vacant

5. #E – Colevan Electric: M – F 8:00AM-5:00PM
6. #F - Vacant
7. #G – Hacienda Construction – by appointment
8. #H – Harvest Mortgage: M – F 8:00AM-5:00PM
9. #J – Eagle Electric: M – F 7:00AM-5:00PM
10. #K – JR Structural Engineering, Inc.: M – F 8:00AM-5:00PM
11. #L – Vacant
12. #M – Western Traffic Supply, Inc.: M – F 8:00AM-4:40PM
13. #O – Rogue Embroidery: M – F 10:00AM-5:00PM
14. #P – DEB Construction, Inc.: M – F 7:00AM-4:30PM

**Available parking space while KPA is using the office**  
**We counted the parking space while we have class.**

<b>Mon</b>	<b>Tue</b>	<b>Wed</b>	<b>Thu</b>	<b>Fri</b>	<b>Sat</b>	<b>Sun</b>
Stretching (9:00AM-10:00AM) <b>7 spaces</b>	Guitar (1:00PM-2:30PM) <b>6 spaces</b>		Art (10:00AM-12:00PM) <b>3 spaces</b>			Violin Lesson (12:00PM-4:00PM) <b>Parking empty</b>
MomChoir practice (10:30AM-12:00PM) <b>10 spaces</b>			Violin Lesson (3:30PM-5:00PM) <b>5 spaces</b>			OPUS Choir practice (4:00PM-6:00PM) <b>Parking empty</b>
				Monthly Book distribution (9:30AM-10:00AM) <b>7 spaces</b>		Chamber Orchestra practice (6:30PM-8:00PM) <b>Parking empty</b>
				Monthly Member Meeting (10:00AM-11:00AM) <b>8 spaces</b>	Occasionally Seminar <b>Parking empty</b>	Monthly Bazaar (3:30PM-4:00PM) <b>Parking empty</b>

				<b>Monthly</b> Book Club Meeting- (4:00PM-5:00AM) (7:00PM-8:00PM)  <b>7 parking spaces</b>	<b>3 times a year</b> Leadership Training  <b>Parking empty</b>	<b>3 times a year</b> Leadership Training  <b>Parking empty</b>
--	--	--	--	---	--	--

**2. Site Plan.**

**3958 Valley Ave**

- A| 1150 sq ft.
- B| 2306 sq ft.
- C| 1728 sq ft.
- D| 1728 sq ft.
- E| 1728 sq ft.
- F| 1728 sq ft.
- G| 2592 sq ft.
- H| 2592 sq ft.

**Total| 15552 sq ft.**

See next page

3942 Valley Ave., Suite D  
1,728 square feet of office and warehouse

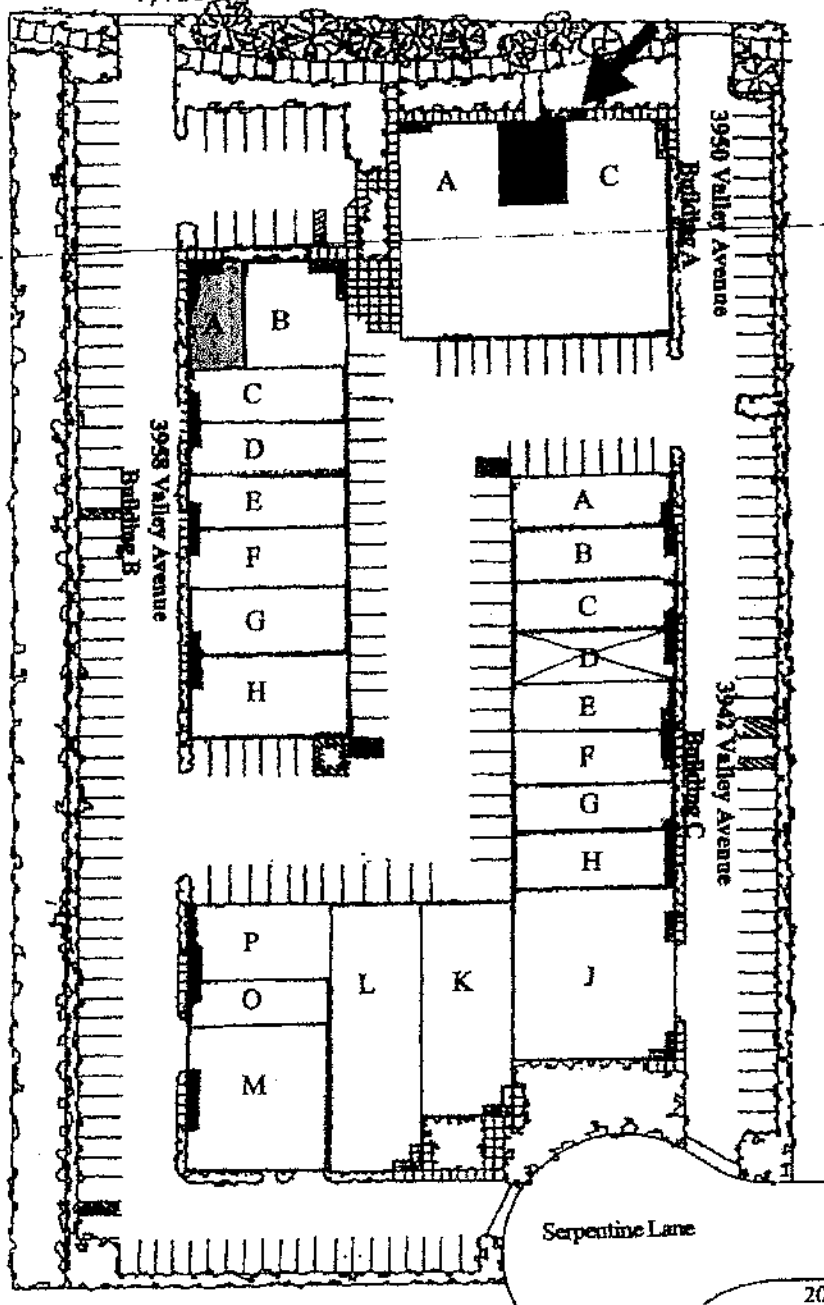

205 Total

### 3. Floor Plan

The 3958 Valley Ave. Site #A is 1150 Sq.Ft large.

And all the walls facing to parking space is grass windows.

We do not have no fixed seats or tables.

We are using folding table and chairs.

We set up just for the events.

In the office – we just have one table for copier and book cases.

See next page



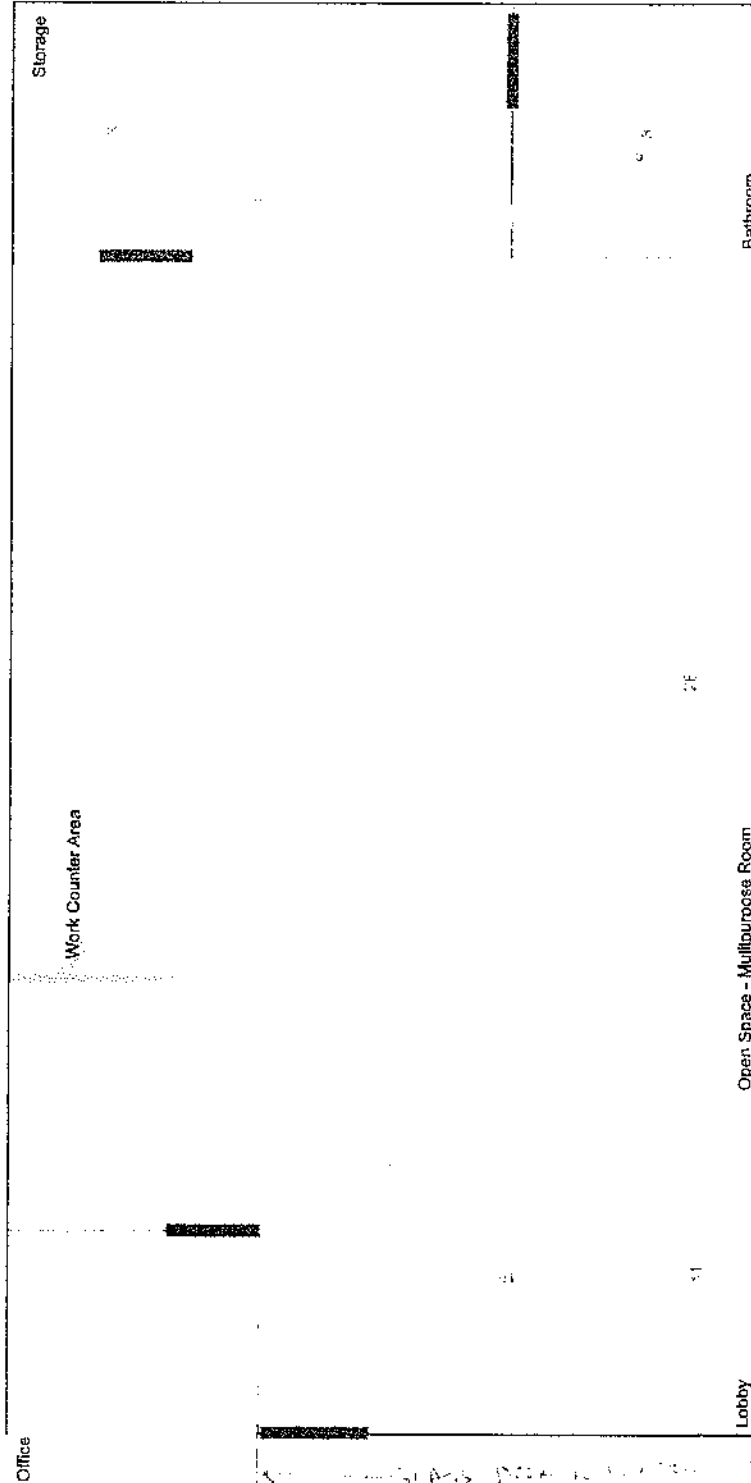

3958 Valley Ave Suite A Pleasanton CA 94566  
Suite: 1150 Sq Ft.

GLW