



Dominguez Design Associates, L.L.C. 8440 Brentwood Blvd., Ste. B, Brentwood, CA 94513 PH: 925-382-6938 FAX: 925-634-1165

American Institute of Building Design The Residential Specialist THIS IS AN ORIGINAL, UNPUBLISHED WORK, AND MAY NOT BE DUPLICATED, PUBLISHED, OR OTHERWISE USED WITHOUT WRITTEN CONSENT OF DOMINGUEZ DESIGN ASSOCIATES, L.L.C. Copyright © DOMINGUEZ DESIGN ASSOCIATES, L.L.C. 2010

Consulting Designer has or intends to copyright the Consulting Design and related Documents. Accordingly, the use of the Consulting Design and related Documents is restricted to the project for which they were prepared. No other use, reproduction, or distribution is permitted without the written consent of the Consulting Designer. The Consulting Designer and related Documents may not be used, altered, transferred, copied, or disseminated in any form or by any means without the express written consent of the Consulting Designer, which is hereby granted to the Consulting Designer's Client.

GENERAL NOTES

- Note: 2010 California Residential Code ("CRC"), 2010 California Electrical Code ("CEC"), 2010 California Fire Code ("CFC"), 2010 California Mechanical Code ("CMC"), and 2010 California Plumbing Code ("CPC") for all sections specified. 1. All materials, workmanship and methods of construction shall conform to the requirements of the UBC, UFC, NEC, CBC, UMC, CPC, and all local building codes, regulations and zoning ordinances. The local governing body shall determine the edition of the codes to be used for the project. Nothing in these documents shall be construed as allowing work not in conformance with the above. 2. Do not scale drawings. Written dimensions shall always take precedence over scale dimensions. Dimensions shown on floor plans are to face of stud unless otherwise noted. 3. The designer shall receive 72 hour advance notice in writing before proceeding if there is the inability to build or implement any portion of the permitted set of Construction Drawings and Related Documents. 4. The Owner/Builder, Contractor, and Subcontractor shall obtain all required inspections from the CITY OF PLEASANTON Building Department for his work. 5. The Owner/Builder, Contractor and/or Subcontractor shall at all times keep the premises free of accumulations of waste materials or rubbish caused by his employees or work. At the completion of the work, he shall remove all his rubbish, all of his tools, scaffolding, and surplus materials from and about the building and shall leave his work "broom clean" or its equivalent. 6. The Owner/Builder, Contractor and/ Subcontractor are to coordinate and verify all sizes of kitchen appliances, to be selected by the Owner/Builder, and the style of the design, materials, hardware and finish of the cabinets with the Owner and cabinetmaker prior to manufacturing.

# SJOBERG CABANA

ABBREVIATIONS

Table of abbreviations including: OVER WITH ANGEL, CENTERLINE, DIAMETER, FINISH FLOOR, FIRE HOSE CABINET, FINISH, F.H.M.S., F.H.W.S., FLOOR, FLASH, FLOUR, F.O.C., FACE OF CONCRETE OR CURB, FACE OF FINISH, F.O.F., F.O.S., FRAMING, FIREPROOF, FRP, FULL SIZE, FOOT OR FEET, FOOTING, FURRING, GALVANIZED IRON, GALVANIZED SHEET METAL, GRAB BAR, GLASS, GLAZING, GROUND, GRANITE, GRADE, GYPSUM, HARDWOOD, HDWE, HOSE BIB, HOLLOW CORE, HEADER, HOLLOW METAL, HORIZONTAL, HOUR, HEIGHT, INSIDE DIAMETER OR CONNECTION, INSULATION, INTERIOR, JAN, JANITOR, JOINT, JOIST, KITCHEN, LABORATORY, LAM, LAMINATE, LAV, LAVATORY, LIN, LINEN, LOCKER, LIGHT, MAX, MAXIMUM, M.C., MEDICINE CABINET, M.D.F., MEDIUM DENSITY FIBERBOARD, M.D.O., MEDIUM DENSITY OVERLAY, M.E.C.H., MECHANICAL, MEMB, MEMBRANE, MET, METAL, MANUFACTURER, MANHOLE, MICRO, MICROWAVE OVEN, MIN, MINIMUM, MIRR, MIRROR, MISC, MISCELLANEOUS, M.O., MASONRY OPENING, M.P., MOISTURE PROOF, MND, MOUNTED, MUL, MULLION, MULD, MULLED, N, NORTH, NEW, NOT IN CONTRACT, NO. or #, NOM, NOMINAL, NS, NEARSIDE, NST, NATURAL STONE, N.T.S., NOT TO SCALE, O.A., OVERALL, OBS, OBSOLETE, O.C., ON CENTER, O.D., OUTSIDE DIAMETER (DIM), O.F.C.I., OWNER FURNISH CONTRACTOR INSTALLED, OFF, OFFICE, OPNG, OPENING, O.P.P., OPPOSITE, O.H., OVERHANG, OVER, ORIENTED STRAND BOARD, PEDESTAL, PRECAST, PLATE, P.L.A.M., PLASTIC LAMINATE, PLAS, PLASTER, PLYWOOD, PAIR, POINT, PRESSURE TREATED, PT.D., PAINTED, PARTN, QUARRY TILE, Q.T., RISER, RAD, RADIUS, R.D., ROOF DRAIN, REF, REFRIGERATOR, REIN.F., REINFORCED, REQ., REQUIRED, RESIL, RESILIENT, RM, ROOM, R.O., ROUGH OPENING, R.H.M.S., ROUND HEAD MACHINE SCREW, R.H.W.S., ROUND HEAD WOOD SCREW, RWD, REDWOOD, R.W.L., RAIN WATER LEADER, S, SOUTH, SBFLR, SUB FLOOR, S.C., SOLID CORE, SCHED, SCHEDULE, S.D., SOAP DISPENSER OR STORM DRAIN, SECT, SECTION, SH, SHELF, SHWR, SHOWER, SHT, SHEET, SHTD, SHEATHING, SIM, SIMILAR, S&P, SHELF AND POLE SPECIFICATION, SPEC, SPECIFICATIONS, S.N.D., SANITARY NAPKIN DISPENSER, SQ, SQUARE, S.S., STAINLESS STEEL, S.S.D., SEE STRUCTURAL DRAWINGS, SLD, SOLID, STA, STATION, STD, STANDARD, STL, STEEL, STOR, STORAGE, STRUC, STRUCTURAL, SUSP, SUSPENDED, SYM, SYMMETRICAL, T, TREAD, T.B., TOWEL BAR, T&B, TOP AND BOTTOM, TBR, TO BE REMOVED, T.C., TOP OF CURB, TEL, TELEPHONE, TEMP, TEMPERED, TERRAZZO, THK, THICK, T.G., TEMPERED GLASS, T&G, TONGUE AND GROVE, THK, THICK, T.P., TOP OF PAVEMENT, T.P.D., TOILET PAPER DISPENSER, T.V., TELEVISION, T.O., TOP, T.O. T, TOP OF NUMBER, T.O.F., TOP OF FRAMING, T.O.S., TOP OF SHEATHING, T.W., TOP OF WALL, TYP, TYPICAL, UNF, UNFINISHED, U.O.N., UNLESS OTHERWISE NOTED, UR, URINAL, V.C.T., VINYL COMPOSITION TILE, V.I.F., VERIFY IN FIELD, VERT, VERTICAL, VET, VESTIBULE, V.W.C., VINYL WALL COVERING, V.W.M., VERIFY WITH MANUFACTURER, WH, WATER HEATER, WL, WROUGHT IRON

CONSULTANTS

DESIGN: Dominguez Design Associates, L.L.C. 8440 Brentwood Blvd. Suite B BRENTWOOD, CALIFORNIA 94513 Tel: (925) 382-6938 Fax: (925) 634-1165

BUILDING DATA

PLANS PREPARED FOR: Craig Sojberg 663 OROFINO PLEASANTON, CA SETBACKS: FRONT 20'-0" REAR 20'-0" SIDES AGGREGATE 15'-0" PROJECT ADDRESS: 663 OROFINO PLEASANTON, CA ZONING: FIRE SPRINKLERS NONE OCCUPANCY & CONST. TYPE : Dwelling: Group R3 TYPE V - B CONSTRUCTION PROJECT SCOPE: PROPOSED 240 S.F. CABANA

MATERIALS

Table of materials with symbols: CONCRETE CAST IN PLACE OR PRECAST, CONCRETE BLOCK, EARTH, GYPSUM BOARD OMIT DOUBLE LINES AT SMALL SCALE, GYPSUM SHEATHING, HARDBOARD, INSULATION, BATT, PLASTER ON METAL LATH, PLYWOOD, RIGID INSULATION, ROCK FILL, SAND, WOOD, FINISH, WOOD, FRAMING THROUGH MEMBER, WOOD, FRAMING INTERRUPTED MEMBER

DRAWING INDEX

Table with drawing index: G1.0 COVER SHEET, C1.0 SITE PLAN, A1.0 FLOOR PLAN, ELEVATIONS AND SECTION, A5.0 DESIGN DETAILS

VICINITY MAP

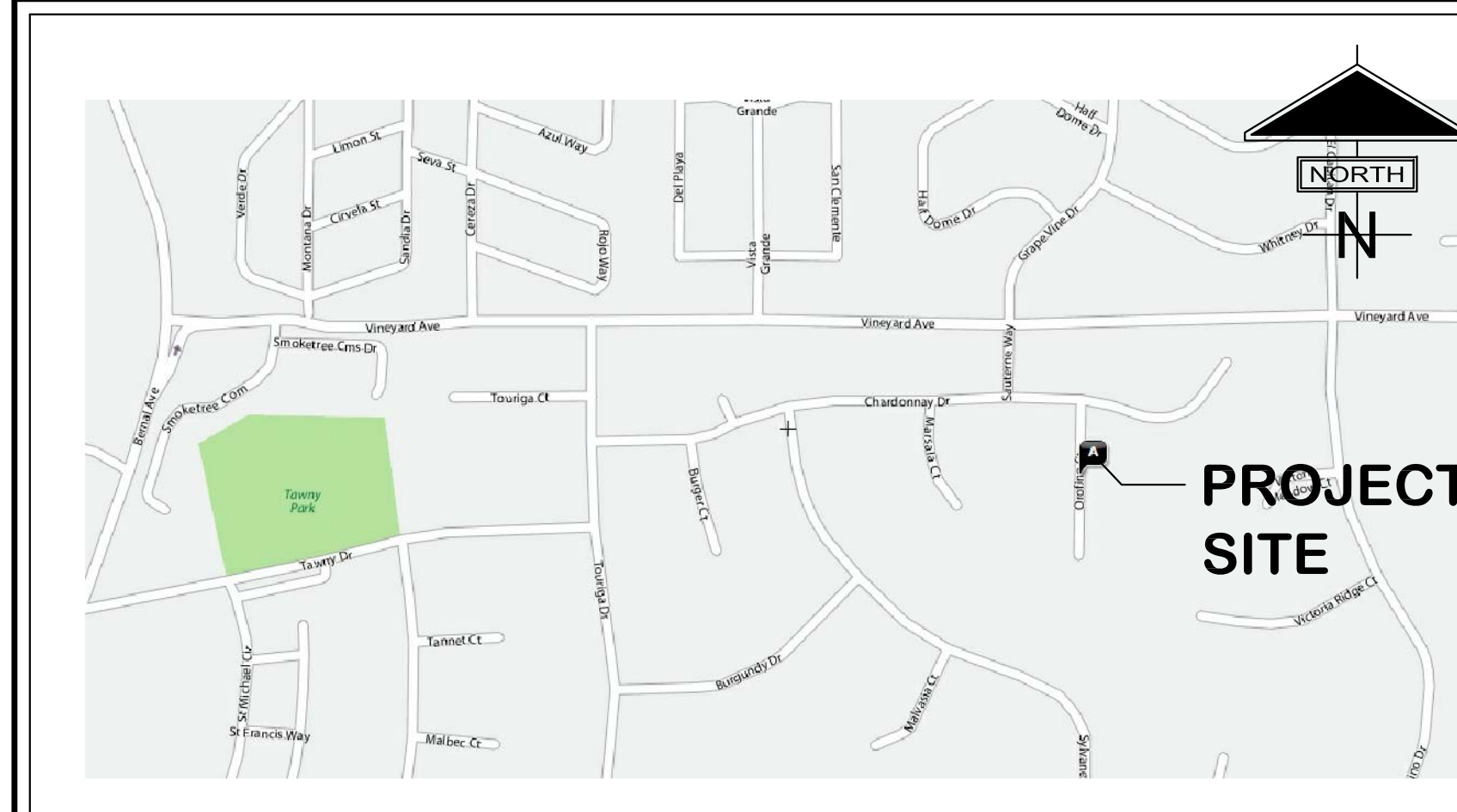

SYMBOLS

Table of symbols: DATUM POINT MARK, NORTH ARROW, INTERIOR ELEVATION MARK, DOOR MARK, WINDOW MARK, ROOM FINISH SCHEDULE, REVISION MARK, ALIGN MARK, SECTION CUT MARK, DETAIL MARK

Table for SUBMITTAL and ISSUE tracking with columns for SYM, REVISIONS, DATE, and ISSUE.

COVER SHEET

## SJOBERG CABANA

663 OROFINO COURT PLEASANTON, CA APN: 946-2554-20

DRAWN BY: GD DATE: 07-29-2011 SCALE: NONE JOB NUM: 1108

SHEET G1.0 OF





