

Tri-Valley – San Joaquin Valley Regional Rail Authority

Valley Link
Connecting People,
Housing and Jobs



Tri-Valley  San Joaquin Valley
REGIONAL RAIL AUTHORITY

The Problem



Tri-Valley San Joaquin Valley
REGIONAL RAIL AUTHORITY

THE BAY AREA GENERATES



6 jobs



1 house

BAY AREA UNSUSTAINABLE HOUSING COSTS



1 house Bay Area



3 houses North
San Joaquin Valley

PEOPLE ON THE MOVE EVERYDAY



121,000

People from Tri-Valley and
San Joaquin Valley

TRAFFIC WILL
INCREASE

60%



2013



2040



Tri-Valley & San Joaquin Valley
REGIONAL RAIL AUTHORITY

15 Members of New Rail Authority

1. Town of Danville
2. City of San Ramon
3. City of Dublin
4. City of Pleasanton
5. City of Livermore
6. City of Tracy
7. City of Lathrop
8. City of Manteca
9. City of Stockton
10. Mountain House Community Services District
11. County of Alameda
12. County of San Joaquin
13. BART
14. San Joaquin Regional Rail Commission
15. LAVTA



Feasibility Report

To provide recommendations for expediting transit connectivity between the BART and ACE systems, to include:

- Preliminary design of project
- Identify preferred entity or entities to operate train
- Develop funding and financing plans
- Proposed schedule



Valley Link Rail Project Delivery

PHASE ONE: IDENTIFY LOCALLY PREFERRED ALTERNATIVE

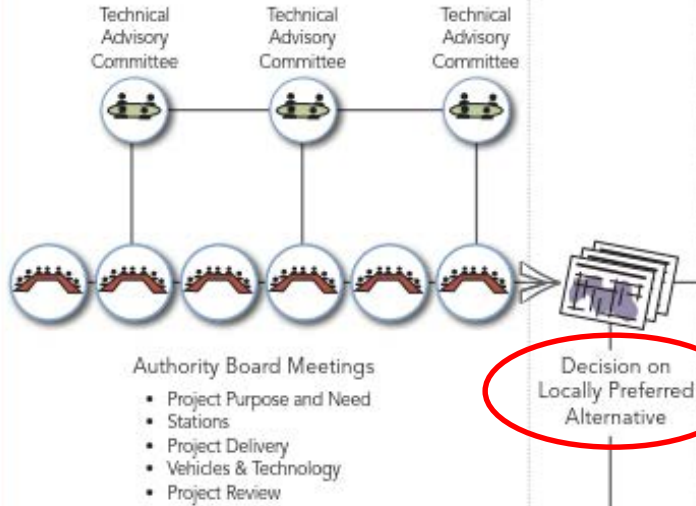

PHASE TWO: ADVANCE ENVIRONMENTAL REVIEW AND PREPARE PROJECT DELIVERY PLAN

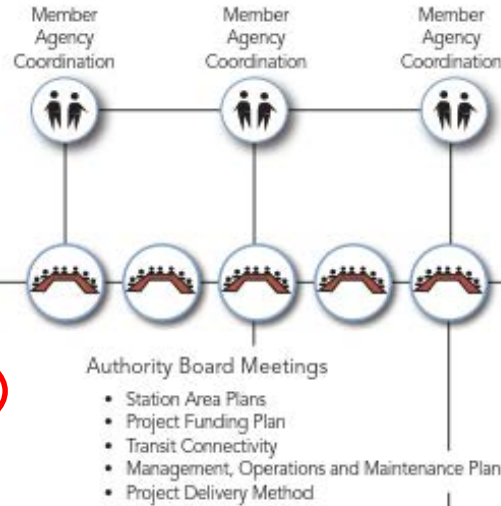

PHASE THREE: DESIGN AND CONSTRUCTION



COMMUNITY COMMUNICATIONS AND ENGAGEMENT

COMMUNITY COMMUNICATIONS AND ENGAGEMENT

Project Feasibility Report

CEQA (EIR)/NEPA (EIS)

2018

JAN FEB MAR APRIL MAY JUNE

JULY-AUG 2018

SEP NOV

2019

FEB APR JUNE

JULY 2019

4-7 YEARS

2023-2026

Valley Link

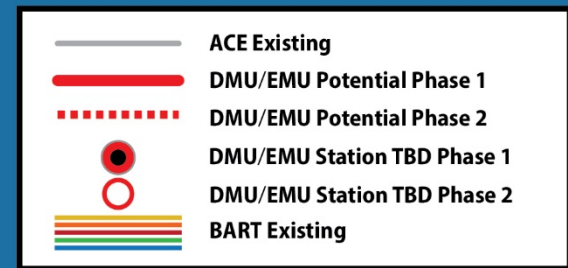



Tri-Valley & San Joaquin Valley
REGIONAL RAIL AUTHORITY

Travel times

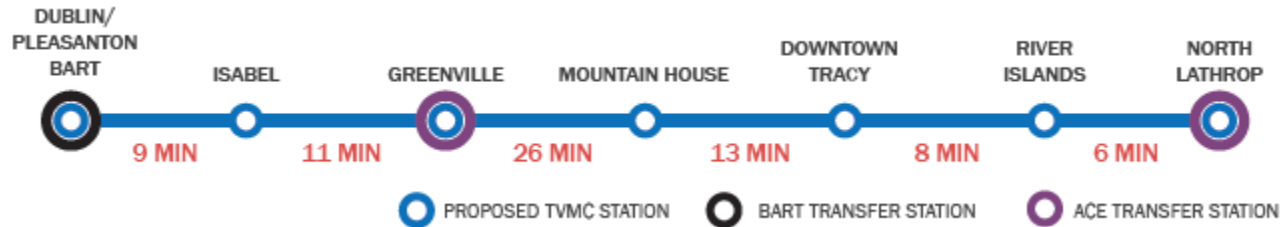

Valley Link versus Driving

	VALLEY LINK	DRIVING: AM PEAK	DRIVING: PM PEAK
MOUNTAIN HOUSE TO DUBLIN/PLEASANTON BART	47 min	35 – 60 min (38 – 22 mph)	35 – 60 min (38 – 22 mph)
GREENVILLE TO DUBLIN/PLEASANTON BART	20 min	16 – 22 min (43 – 31 mph)	20 – 40 min (35 – 17 mph)
ISABEL TO DUBLIN/PLEASANTON BART	10 mins	10 – 14 min (36 – 26 mph)	9 – 16 min (40 – 23 mph)



Traffic expected to increase 59% over the Altamont Pass by 2040



AM traffic to slow from 35 mph to 26 mph; PM from 49 mph to 35 mph by 2040



Dublin/Pleasanton BART Connection – Section B close-up view of station platforms

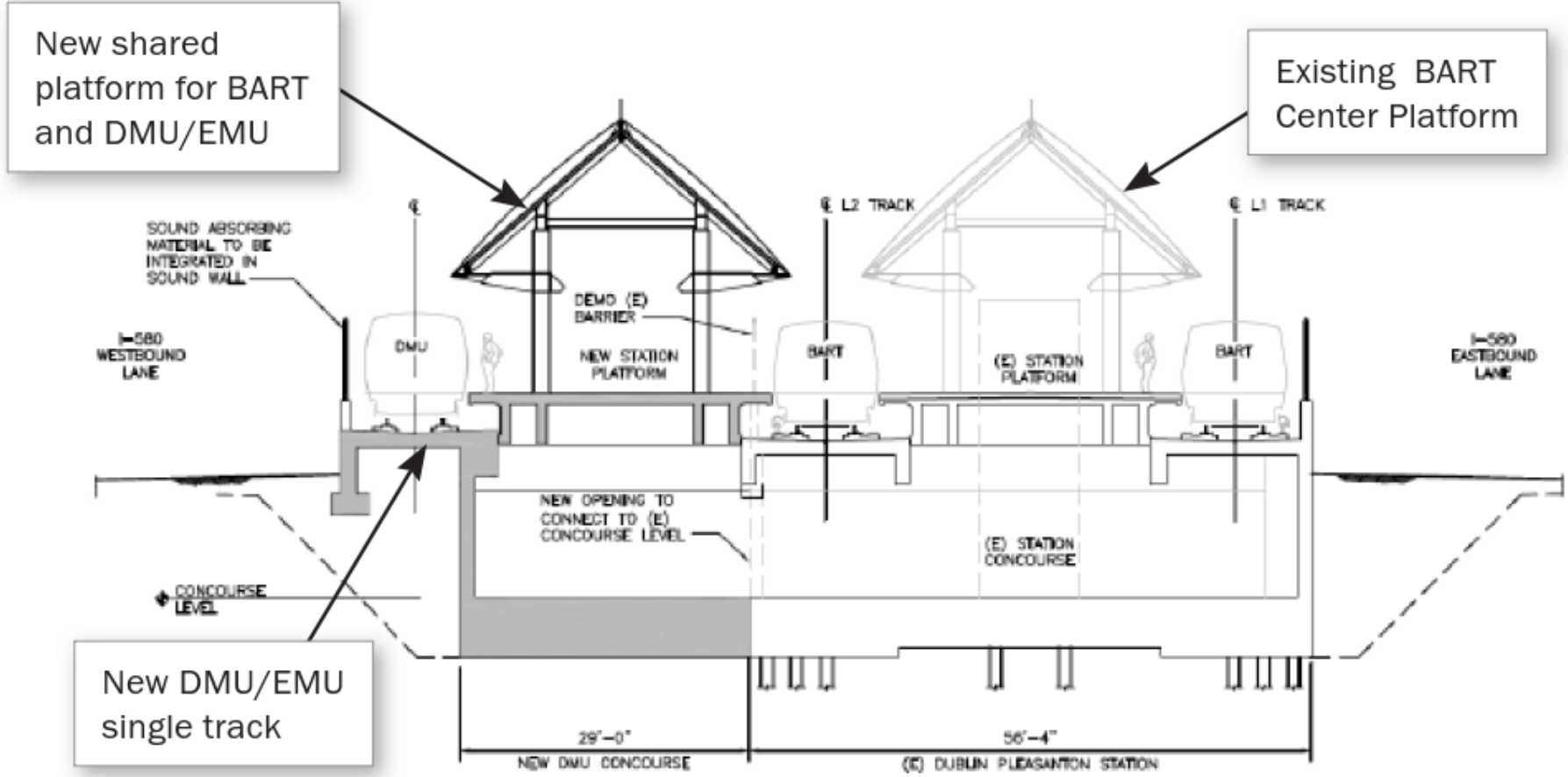

BART Connection



Contact Information

Michael Tree, Executive Director

mtree@acetobart.org

925-455-7564

www.acetobart.org



Tri-Valley  San Joaquin Valley
REGIONAL RAIL AUTHORITY